

Simplifying your meetings,
conventions, banquets, and exhibitions



513-771-7744
sharonvilleconventioncenter.com



Main Level Floor Plan

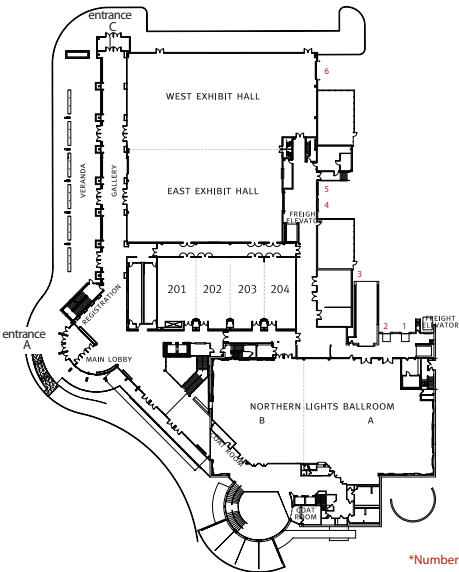

The Northern Lights Ballroom can accommodate a wide range of events and seats up to 1,000 persons for banquets. The Sharonville Convention Center staff will work with you to help your event run seamlessly.

*Numbers 1-6 = Dock Doors

Room Number/Name	ROOM SIZE			ROOM CAPACITY					
	Dimensions	Sq. Ft.	Ceiling Height	Theatre	Classroom	Banquet Rounds (8)	Hollow Square	Reception	8 x 10 Booths
201	31 x 55	1705	14	196	108	96	56	206	
202	27 x 57	1539	14	175	102	104	56	180	
203	27 x 57	1539	14	175	102	104	56	180	
204	25 x 57	1425	14	150	102	104	56	166	
Combined	110 x 57	6270	14	702	396	424		733	42
Northern Lights Ballroom A	104 x 83	8717	19	1063	663	592		1070	59
Northern Lights Ballroom B	73 x 83	5350	19	626	414	384		635	36
Combined	177 x 83	14067	19	1648	1119	1000		1705	100
West Exhibit Hall	151 x 76	11476	20	1348	840	760		1450	80
East Exhibit Hall	123 x 73	8979	20	1142	720	648		1200	63
Combined	151 x 149	20455	20	2395	1437	1408		2650	144
Gallery	175 x 20	3500						325	
Veranda	175 x 20	3500						325	

*Maximum capacities are listed above and do not allow for audio visual, extra tables, or spacious room sets. Please plan accordingly.

Lower Level Floor Plan

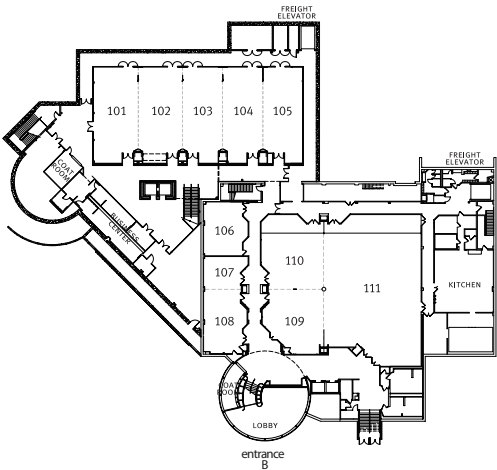

Our new digital signage welcomes visitors and provides the daily event schedule and room locations.

Room Number	ROOM SIZE			ROOM CAPACITY					
	Dimensions	Sq. Ft.	Ceiling Height	Theatre	Classroom	Banquet Rounds (8)	Hollow Square	Reception	8 x 10 Booths
101	26 x 58	1508	14	175	102	104	56	200	
102	27 x 58	1566	14	175	102	104	56	200	
103	24 x 58	1392	14	170	102	104	56	190	
104	24 x 58	1392	14	170	102	104	56	190	
105	24 x 58	1392	14	166	96	104	56	185	
Combined	127 x 58	7366	14	800	483	520		965	46
106	27 x 33	891	12	90	45	48	32	120	
107	27 x 20	540	12	50	24	32	21	55	
108	27 x 39	1053	12	120	60	64	40	130	
107/108	27 x 59	1593	12	170	93	96	52	175	
109	38 x 40	1520	14	135	72	88	36	145	
110	38 x 45	1710	14	170	99	104	44	180	
109/110	38 x 85	3230	14	299	180	192		320	
111	59 x 85	5015	14	550	372	368		560	
109/110/111	97 x 85	8245	14	880	546	560		924	50

*Maximum capacities are listed above and do not allow for audio visual, extra tables, or spacious room sets. Please plan accordingly.



Northern Cincinnati's Premier Meeting & Event Facility

The Sharonville Convention Center, in Cincinnati's northern suburbs, is an exciting venue for meetings, conventions, banquets, trade shows and public events.

Our Expanded and Renovated Center is Now Open!

The features of the New Center Include:

- 20,000 square foot Exhibit Hall
- A beautiful new 14,000 square foot Ballroom
 - 8,200 square foot room divisible by 3
 - 7,400 square foot room divisible by 5
 - 6,300 square foot room divisible by 4
- 3 additional break-out rooms

New technologies including electronic signage, message boards, complimentary wi-fi and an innovative projection wall at the entrance to welcome your guests.

- Built-in registration areas and ticket counters

The Sharonville Convention Center offers excellent food and beverage service provided by Ovations Food Services, prepared in our own state-of-the-art kitchens.

Located near I-75, 15 miles north of downtown Cincinnati and 25 miles south of Dayton, the Convention Center is easily accessible from any direction.

Nearby are 22 hotels with more than 3,000 guest rooms, plus a wide variety of dining and entertainment options.

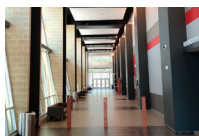

513-771-7744

11355 Chester Road Sharonville, OH 45246

sharonvilleconventioncenter.com